

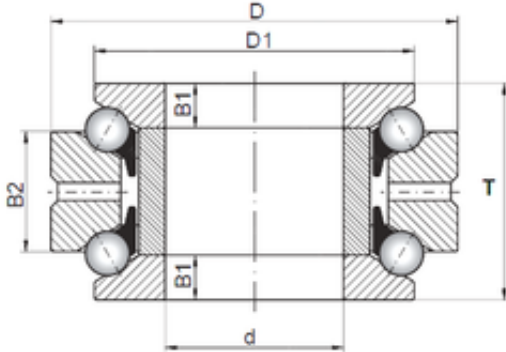

BEARING CORP. LTD.

ISO 234756 thrust ball bearings



Bearing No. 234756

Size	289x420x164 mm
Bore Diameter	289 mm
Outer Diameter	420 mm
Width	164 mm
d	289 mm
D	420 mm
T	164 mm
B1	41 mm
B2	82 mm
D1	374 mm

234756 Bearing 2D drawings and 3D CAD models