

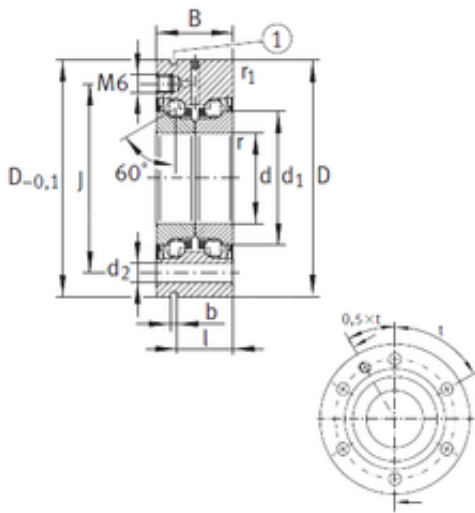

BEARING CORP. LTD.

50 mm x 115 mm x 34 mm INA ZKLF50115-2RS-PE thrust ball bearings



Bearing No. ZKLF50115-2RS-PE

ZKLF50115-2RS-PE Bearing 2D drawings and 3D CAD models

Size	50x115x34 mm
Bore Diameter	50 mm
Outer Diameter	115 mm
Width	34 mm
d	50 mm
D	115 mm
B	34 mm
C	34 mm
Screw	6
l	25 mm
Angle (?)	60 °
b	3 mm
d1	72 mm
d2	8,8 mm
r min.	0,3 mm
r1 min.	0,6 mm
J	94 mm
Bolt (G)	M8
Weight	1,86 Kg
Basic dynamic load rating (C)	46,5 kN
Basic static load rating (C0)	126 kN
Category	Precision Ball Bearings
Inventory	0.0
Manufacturer Name	SCHAEFFLER GROUP
Minimum Buy Quantity	N/A



BEARING CORP. LTD.

Weight / Kilogram	2.227
EAN	4012802427332
Product Group	B00152
Enclosure	2 Seals
Precision Class	ABEC 5 ISO P5
Material - Ball	Steel
Number of Bearings	1 (Single)
Contact Angle	60 Degree
Preload	None
Raceway Style	Not Applicable
Cage Material	Plastic
Rolling Element	Ball Bearing
Enclosure Type	Contact Seal
Flush Ground	No
Inch - Metric	Metric
Other Features	Double Row Angular Contact Thrust Bearing Double Direction Ball Screw Support
Long Description	50MM Bore; 115MM Outside Diameter; 34MM Width; 2 Seals Enclosure; ABEC 5 ISO P5 Precision; Steel Ball Material; 1 (Single) Bearing; 60 Degree Contact Angle; Plastic Cage Material; Ball Bearing
Category	Precision Ball Bearings
UNSPSC	31171531
Harmonized Tariff Code	8482.10.50.28
Noun	Bearing
Keyword 3	Thrust
Keyword String	Ball Angular Contact Thrust
Manufacturer URL	http://www.ina.com
Weight / LBS	4.10059



BEARING CORP. LTD.

Outside Diameter	4.528 Inch 115 Millimeter
Bore	1.969 Inch 50 Millimeter
Width	1.339 Inch 34 Millimeter