

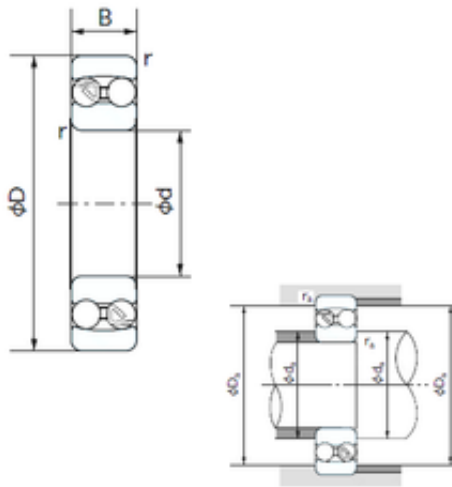

# BEARING CORP. LTD.



55 mm x 100 mm x 25 mm NACHI 2211 self aligning ball bearings

Bearing No. 2211

Size	55x100x25 mm
Bore Diameter	55 mm
Outer Diameter	100 mm
Width	25 mm
d	55 mm
D	100 mm
B	25 mm
C	25 mm
r1 min.	1.5 mm
da min.	66 mm
Da max.	92 mm
ra max.	1.5 mm
Weight	0.810 Kg
Basic dynamic load rating (C)	26,8 kN
Basic static load rating (C0)	10 kN
(Grease) Lubrication Speed	5800 r/min
(Oil) Lubrication Speed	7100 r/min
Calculation factor (e)	0.20
Calculation factor (Y0)	3.34
Calculation factor (Y1)	3.19

2211 Bearing 2D drawings and 3D CAD models