

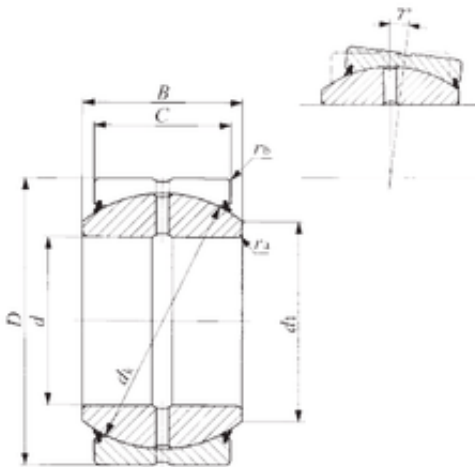

BEARING CORP. LTD.

31.75 mm x 50,8 mm x 27,76 mm IKO SBB 20-2RS plain bearings



Bearing No. SBB 20-2RS

Size	31.75x50.8x27.76 mm
Bore Diameter	31.75 mm
Outer Diameter	50,8 mm
Width	27,76 mm
d	31.75 mm
D	50,8 mm
B	27,76 mm
C	23,8 mm
d1	35,1 mm
dk	45 mm
ra max.	0,6 mm
rb max.	0,8 mm
Weight	0,234 Kg
Basic dynamic load rating (C)	105 kN

SBB 20-2RS Bearing 2D drawings and 3D CAD models