

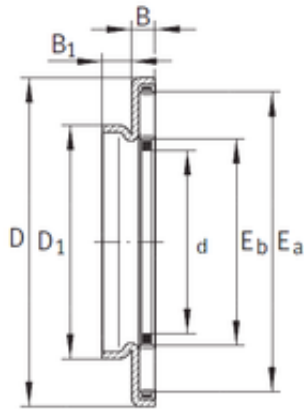

# BEARING CORP. LTD.

20 mm x 38 mm x 3,2 mm INA AXW20 needle roller bearings

Bearing No. AXW20



AXW20 Bearing 2D drawings and 3D CAD models

Size	20x38x3.2 mm
Bore Diameter	20 mm
Outer Diameter	38 mm
Width	3,2 mm
d	20 mm
D	38 mm
B	3,2 mm
B1	3,5 mm
D1	26 mm
Ea	22 mm
Eb	34 mm
Weight	14 Kg
Basic dynamic load rating (C)	13,1 kN
Basic static load rating (C0)	46,5 kN
Fatigue load limit (Pu)	4,75
Reference speed	4 900 r/min
Category	Thrust Roller Bearing
Inventory	0.0
Manufacturer Name	SCHAEFFLER GROUP
Minimum Buy Quantity	N/A
Weight / Kilogram	0.01
EAN	4012802032833
Product Group	B04144
Rolling Element	Needle Roller Bearing
Self Aligning	No



## BEARING CORP. LTD.

Component Description	Roller Assembly with Center Washer
Thrust Bearing	Yes
Single or Double Direction	Single Direction
Banded	No
Cage Material	Steel
Precision Class	ABEC 1   ISO P0
Other Features	Single Row   Piloted   With Centering Spigot   Axial Needle Roller
Long Description	20MM Bore 1; 20MM Bore 2; 38MM Outside Diameter; 2MM Height; 6.7MM Overall Height with Aligning Washer; Needle Roller Bearing; Single Direction; Not Self Aligning; Not Banded; Steel Cage; ABEC 1   ISO
Inch - Metric	Metric
Category	Thrust Roller Bearings
UNSPSC	31171507
Harmonized Tariff Code	8482.40.00.00
Noun	Bearing
Keyword 3	Needle
Keyword String	Thrust Roller Needle
Manufacturer URL	<a href="http://www.ina.com">http://www.ina.com</a>
Manufacturer Item Number	AXW20
Weight / LBS	0.031
Bore 1	0.787 Inch   20 Millimeter
Height	0.079 Inch   2 Millimeter
Overall Height with Aligning Washer	0.264 Inch   6.7 Millimeter
Outside Diameter	1.496 Inch   38 Millimeter
Bore 2	0.787 Inch   20 Millimeter