

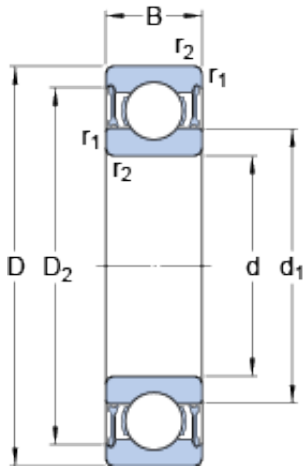

BEARING CORP. LTD.



50 mm x 80 mm x 16 mm SKF W 6010-2RZ
deep groove ball bearings

Bearing No. W 6010-2RZ

W 6010-2RZ Bearing 2D drawings and 3D CAD models

Size	80x50x16 mm
Bore Diameter	80 mm
Outer Diameter	50 mm
Width	16 mm
d	50 mm
D	80 mm
B	16 mm
d ₁	60 mm
D ₂	74.55 mm
r _{1,2} - min.	1 mm
D _a - max.	75 mm
r _a - max.	1 mm
Basic dynamic load rating - C	19 kN
Basic static load rating - C ₀	16.6 kN
Fatigue load limit - P _u	0.71 kN
Reference speed	18000 r/min
Limiting speed	9000 r/min
Calculation factor - k _r	0.03
Calculation factor - f ₀	15.6
d ₁	60 mm
D ₂	74.55 mm
r _{1,2} min.	1 mm
d _a min.	55 mm
d _a max.	59.5 mm



BEARING CORP. LTD.

D_a max.	75 mm
r_a max.	1 mm
Basic dynamic load rating C	19 kN
Basic static load rating C_0	16.6 kN
Fatigue load limit P_u	0.71 kN
Calculation factor k_r	0.03
Calculation factor f_0	15.6
Mass bearing	0.26 kg