

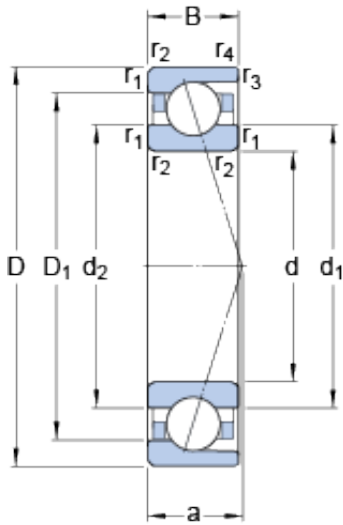

# BEARING CORP. LTD.



105 mm x 130 mm x 13 mm SKF 71821 CD/P4  
angular contact ball bearings

Bearing No. 71821 CD/P4

71821 CD/P4 Bearing 2D drawings and 3D CAD models

Size	130x105x13 mm
Bore Diameter	130 mm
Outer Diameter	105 mm
Width	13 mm
d	105 mm
D	130 mm
B	13 mm
d <sub>1</sub>	113.2 mm
d <sub>2</sub>	113.2 mm
D <sub>1</sub>	122 mm
r <sub>1,2</sub> - min.	1 mm
r <sub>3,4</sub> - min.	0.3 mm
a	22.3 mm
d <sub>a</sub> - min.	109.6 mm
d <sub>b</sub> - min.	109.6 mm
D <sub>a</sub> - max.	125.4 mm
D <sub>b</sub> - max.	128 mm
r <sub>a</sub> - max.	1 mm
r <sub>b</sub> - max.	0.3 mm
d <sub>n</sub>	114.6 mm
Basic dynamic load rating - C	22.9 kN
Basic static load rating - C <sub>0</sub>	30 kN
Fatigue load limit - P <sub>u</sub>	1.2 kN
Limiting speed for grease	9000 r/min



## BEARING CORP. LTD.

Lubrication	
Limiting speed for oil lubrication	14000 mm/min
Ball - $D_w$	7.144 mm
Ball - $z$	35
$G_{ref}$	4 cm <sup>3</sup>
Calculation factor - $f_0$	17.4
Preload class A - $G_A$	130 N
Preload class B - $G_B$	390 N
Preload class C - $G_C$	780 N
Calculation factor - $f$	1.44
Calculation factor - $f$	1
Calculation factor - $f_{2A}$	1
Calculation factor - $f_{2B}$	1.09
Calculation factor - $f_{2C}$	1.16
Calculation factor - $f_{HC}$	1
Preload class A	96 N/micron
Preload class B	167 N/micron
Preload class C	250 N/micron
$d_1$	113.2 mm
$d_2$	113.2 mm
$D_1$	122 mm
$r_{1,2}$ min.	1 mm
$r_{3,4}$ min.	0.3 mm
$d_a$ min.	109.6 mm
$d_b$ min.	109.6 mm
$D_a$ max.	125.4 mm
$D_b$ max.	128 mm
$r_a$ max.	1 mm
$r_b$ max.	0.3 mm
$d_n$	114.6 mm



## BEARING CORP. LTD.

Basic dynamic load rating C	22.9 kN
Basic static load rating $C_0$	30 kN
Fatigue load limit $P_u$	1.18 kN
Attainable speed for grease lubrication	9000 r/min
Attainable speed for oil-air lubrication	14000 r/min
Ball diameter $D_w$	7.144 mm
Number of balls z	35
Reference grease quantity $G_{ref}$	4 cm <sup>3</sup>
Preload class A $G_A$	130 N
Static axial stiffness, preload class A	96 N/μm
Preload class B $G_B$	390 N
Static axial stiffness, preload class B	167 N/μm
Preload class C $G_C$	780 N
Static axial stiffness, preload class C	250 N/μm
Calculation factor f	1.44
Calculation factor $f_1$	1
Calculation factor $f_{2A}$	1
Calculation factor $f_{2B}$	1.09
Calculation factor $f_{2C}$	1.16
Calculation factor $f_{HC}$	1
Calculation factor $f_0$	17.4
Mass bearing	0.32 kg